



# AMD Direct

---

KEGENERATOR  
USER MANUAL

---

### AMD DIRECT KEGERATOR INSTALLATION INSTRUCTIONS & OWNERS MANUAL

**NAME:** 24" 6.6C DELUXE OUTDOOR RATED NO TAP KEGERATOR  
 24" 6.6C DELUXE OUTDOOR RATED SINGLE TAP KEGERATOR  
 24" 6.6C DELUXE OUTDOOR RATED DUAL TAP KEGERATOR

**PART #:** SSRFR-24DK  
 SSRFR-24DK1  
 SSRFR-24DK2

### THANK YOU

Thank you for your purchase. We'd like to welcome you to the AMD Direct family of luxury outdoor kitchen products and look forward to being a part of your home for years to come. As a family business with over 20 years of industry experience, we aim to deliver exceptional quality and personal service. Welcome to the AMD Direct family and we hope you love your new kegerator!



For warranty information and to register your kegerator visit,  
[AMDDirect.com/register](http://AMDDirect.com/register)  
 To view on your phone, scan the QR code on your camera app,  
 camera app. (For Android devices, use Google Lens)

### INSTALLER

Please leave this manual for the owner

Serial Number: \_\_\_\_\_  
 Model: \_\_\_\_\_  
 Date of Purchase: \_\_\_\_\_  
 Piece of Purchase: \_\_\_\_\_



## SAFETY AND INSTALLATION INSTRUCTIONS

**⚠ WARNING**

Before the appliance is used, it must be properly positioned and installed as described in this manual, so read the manual carefully. To reduce the risk of fire, electrical shock or injury when using the appliance, follow basic precautions, including the following:

- Plug into a grounded 3-prong outlet; do not remove prong, do not use an adapter, and do not use an extension cord.
- Replace all panels before operating.
- It is recommended that a separate circuit serving only your appliance be provided. Use receptacles that cannot be turned off by a switch or pull chain.
- Never clean appliance parts with flammable fluids. These fumes can create a fire hazard or explosion.
- Do not store or use gasolines or other flammable vapors and liquids in the vicinity of this or any other appliance. The fumes can create a fire hazard or explosion.
- Do not connect or disconnect the electric plug when your hands are wet.
- Unplug the appliance or disconnect power before cleaning or servicing. Failure to do so can result in electrical shock or death.
- Do not attempt to repair or replace any part of the appliance unless specifically recommended in this manual. All other servicing should be referred to a qualified technician.

**⚠ CAUTION**

1. Stainless steel exposed to chlorine gas and moisture – such as areas with spas or swimming pools – may experience discoloration. This discoloration from chlorine gas is normal.
2. NEVER USE CHLORIDE TO CLEAN STAINLESS STEEL.

### POWER FAILURE

Most power failures are corrected within a few hours and should not affect temperature of your appliance if you minimize the number of times the drawer is opened. If the power is going to be off for a longer period of time, take proper steps to protect the contents.

### VACATION TIME

**Short Vacations:** Leave the appliance operating during vacations or less than three weeks.

**Long Vacations / Winterizing:** If the appliance will not be used for several months, drain the beer lines, remove all items and turn off the appliance. Clean and dry the interior thoroughly. Protect the exterior with a coat of stainless steel polish. To prevent mold, clean the inside of the door of baking soda inside and leave the door open slightly, blocking it open if necessary.

### MOVING YOUR APPLIANCE

- Remove all items.
- Securely tape down all loose items inside your appliance.
- Tilt the appliance legs up to the base to avoid damage.
- Tape the door shut.
- Be sure the appliance stays secure in the upright position during transportation. Also protect the outside of the appliance with a blanket or similar item.

## GENERAL SAFETY REQUIREMENTS

**⚠ WARNING**

**FOLLOW WARNING CALLOUTS BELOW ONLY WHEN APPLICABLE TO YOUR MODEL**

- Use two or more people to move and install appliance. Failure to do so can result in back injury.
- To ensure proper ventilation for your appliance, the front of the unit must be completely unobstructed.
- Choose a well-ventilated area with temperatures above 50°F (10°C) and below 103.4°F (40°C).
- The appliance should not be located next to ovens, grills, or other sources of high heat.
- The appliance must be installed with all electrical, water, and drain connections in accordance with state and local codes. A standard electrical supply (115 V AC only, 60Hz), properly grounded in accordance with the National Electrical Code and local codes is required.
- Do not kink or pinch the power supply cord of the appliance.
- The size of the fuse (or circuit breaker) should be 1.3 amperes.
- It is important that the appliance be leveled in order to work properly. You may need to make adjustments to the leveling legs.
- All installations must be in accordance with local plumbing code requirements.
- Never allow children to operate, play with or crawl inside the appliance.
- Do not use solvent-based cleaning agents or abrasives on the interior. These cleaners may damage the interior.
- Use this appliance only for its intended purpose as described in this instruction manual.
- Keep fingers out of the "pinch point" areas. Clearances between the drawer and cabinet are necessarily small. Be careful closing drawer when children are in the area.

**ENERGY SAVING TIPS**

- The appliance should be located in the coolest area of the room or outdoor location, away from heat-producing appliances and out of direct sunlight.
- Do not overload the beer dispenser as it will affect the temperature of the beer.
- Position items so that air can circulate freely around them.
- Do not leave door open for longer than required.
- Make sure items do not touch the back of the storage compartment.
- The thermostat should be set to a temperature most to exceedingly cold temperatures.



**KEGERATOR  
USER MANUAL**

---

**TABLE OF CONTENTS**

BEFORE OPERATING	1
TROUBLESHOOTING	2
OPERATING YOUR APPLIANCE	3
INSTALLATION	4
WARRANTY	6



KEGERATOR USER MANUAL



## OPERATING YOUR APPLIANCE

### CONTROL PANEL

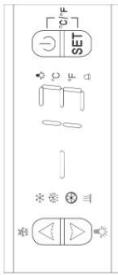

### OPERATION INSTRUCTION

The Kegerator is able to maintain the proper temperature in the keg. The unit should be installed correctly in the proper environment. For best results, mount the draft tower as close to the top of the keg as possible and seal any openings to prevent heat transfer. Avoid opening and closing the door of the keg too often to ensure a consistent temperature inside the unit. Factory preset temperature is 36 degrees Fahrenheit.

The Kegerator should be placed in an area where the ambient temperature range is between 50-109.4 degrees Fahrenheit (10-43 degrees Celsius). If the ambient temperature is above or below this range, the performance of the unit may be affected. For example, placing your unit in extreme cold or heat may cause the temperature to fluctuate. Please be aware that the desired temperatures may fluctuate depending on the ambient temperature and the orientation of the keg.

**ON/OFF POWER**   
To turn the appliance ON or OFF, press and hold the POWER key for 5 seconds.

**UP AND DOWN**   
Press first, then press or button to increase (hot) the set temperature by 1°C/1°F. Press again, the temperature is selected and shows the actual temperature. If no other further operation in 6 seconds, display will show actual temperature in the cooler.

**\*F/C SELECTOR**   
Selects the temperature display setting in Fahrenheit or Celsius degrees. To change the temperature from Fahrenheit to Celsius or from Celsius to Fahrenheit, press and at the same time, then hold for 6 seconds.

**SETTING THE TEMPERATURE CONTROL**   
To set the temperature, press and hold the key for one degree each time you press the key and will decrease by one degree each time you press the key.

The range of temperature control is from 32°F to 50°F. To view the set temperature at any time, press the key. The set temperature will flash in the display window for 6 seconds. After 6 seconds, the temperature inside the unit will reappear in the display window. (The temperature preset at the factory is 36°F)

## INSTALLATION

### STEP 1

Unpackage your kegerator and lay out the kegerator parts on a flat surface, ensuring you have the following:



- 1. CO2 Regulator
- 2. Red Hose
- 3. Keg Tap Handle
- 4. CO2 Tank
- 5. 4x Short Bolts
- 6. 4x Metal Washers
- 7. 4x Short Bolts
- 8. 4x Long Bolts
- 9. Tap Tray

### STEP 2

Then, guide the translucent hose through the kegerator opening, or if you have an island, as shown, guide it through both openings. If mounting to a counter-top, secure your tower using the four long bolts & nuts, and 2 rubber washers. If mounting directly onto your kegerator, use the 4 short bolts and metal washers.



### STEP 3

Now, screw the tap handle onto the Keg Tap, and fasten the Keg Tap to the tower by rotating counterclockwise.

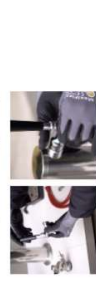

### STEP 4

Locate the translucent hose connected to the Keg Tap. Then, connect the hose to the Keg Coupler to your keg by pushing down and twisting clockwise to lock it in. **\*DO NOT PUSH DOWN THE BLACK LEVER ON KEG COUPLER\***



### STEP 5

Then, attach the regulator to the CO2 tank, using an adjustable wrench to avoid leakage. Place a metal fastener around the neck of the red hose, and attach the hose to the middle of the regulator. Tighten the fastener clockwise. Then, attach the metal fastener around the other end of the red hose, and attach to the nozzle on the Keg Coupler. Tighten the metal fastener. Twist counterclockwise to open the CO2 tank. Unscrew the pressure valve until loose, and then re-screw until the pressure gauge reads "12"



### STEP 6

Place your CO2 tank onto the shelf, and then lift the Keg into the kegerator. Tap your keg by pulling out the black lever of your Keg Coupler, pushing down, and releasing. Make sure your keg assembly cools before use. Place the Tap Tray below the tap.



FOUR AND ENJOY!

## INSTALLATION

### REPLACE ALL PANELS BEFORE OPERATING

This appliance should be properly grounded for your safety. The power cord of this appliance is equipped with a ground fault interrupter (GFI) and a three-prong wall outlet to minimize the possibility of electrical shock.

Do not under any circumstance cut or remove the third (ground) prong from the power cord supplied. For personal safety, this appliance must be properly grounded. If you are unable to ground the appliance or grounding would be directed toward a certified electrician or an authorized service center.

The appliance requires a standard 115/220 Volt AC-60Hz three-prong grounded electrical outlet. Have the wall outlet and circuit checked by a qualified electrician. Make sure the outlet is properly grounded. When the power cord is plugged into the outlet, it is your responsibility and obligation to have it replaced with a properly grounded 3-prong wall outlet.

To prevent accidental injury, the cord should be secured behind the appliance and not left exposed dangling.

The appliance should always be plugged into its own individual electrical outlet which has a voltage rating that matches the rating label on the appliance. This provides the best performance and also prevents overloading house wiring circuits that may cause overheating and fire. Do not pull on the cord, always grip the plug firmly and pull straight out from the receptacle. Repair or replace immediately all power cords that have become frayed or otherwise damaged. Do not use a cord that shows cracks or abrasion damage along its length or at either end. When moving the appliance, be careful not to damage the power cord.

**⚠ WARNING ⚠**

Improper use of the grounded plug can result in the risk of electrical shock. If the power cord is damaged, have it replaced by a qualified or an authorized service dealer.

### EXTENSION CORD

Because of potential safety hazards under certain conditions, it is strongly recommended that you do not use an extension cord with this appliance. However, if you must use an extension cord it is absolutely necessary that it be a UL/CUL-Listed, 3-wire grounding type appliance extension cord having a ground type plug and outlet and that the electrical rating of the cord be 115 volts and at least 1.3 amperes.

**INSTALLING THE STAINLESS STEEL HANDLE**  
This appliance includes a stainless steel handle that is not required to operate this unit. To install the handle please follow the below instructions:

1. Pull away the door gasket in the area where the handle is to be installed as shown in illustration. The gasket is easily displaced by hand, no tools are required.
2. Locate the screws included in the bag with the user's guide. Insert the screws into the holes as shown.
3. Align the handle with the screws installed. Tighten the screws using a Phillips head screwdriver until the handle sets both flush and seated tightly against the door frame. (DO NOT over-tighten as this will cause damage to the handle assembly).
4. Replace the door gasket to its original position.

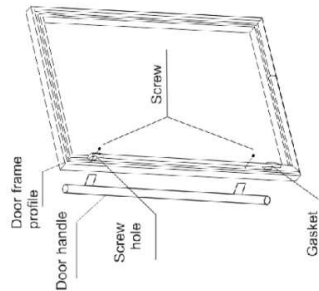



AMD Direct

## GOLD STANDARD WARRANTY

Your investment in AMD Direct product is backed by the strongest warranty in the industry. In addition to precision engineering and outstanding performance, AMD Direct products include our GOLD STANDARD LIFETIME WARRANTY with all replacement parts 100% non-prorated. Effective with purchases 8/1/21.

AMD Direct Warranty is valid for original purchaser at original site of delivery with proof of purchase and photo documentation only. Registration form must be submitted online within 30 days of the purchase date to validate the warranty. Warranty is void upon transfer of ownership. Warranty does not apply to products installed in any commercial, rental, or nonresidential application (exception of the Resort Grill, Alturi, & TRL). Warranty covers replacement parts only. Manufacturer is not responsible for labor or labor-related costs. Warranty does not cover discoloration, surface rust, corrosion, or oxidation, which may occur due to harsh environments, chemicals, or overheating. Warranty will not apply for damage resulting from improper installations, abuse, extreme environments, grease fires, or misuse. Proof of regular and proper maintenance is required. Coastal, humid, and/or salt environments are subject to manufacturer review. All out-of-box claims must be made within 30 days of purchase and must be made prior to installation. Any product installed damaged will be considered damaged during installation and not covered under warranty. Warranty and registration forms are available at [www.amddirect.com/register](http://www.amddirect.com/register). Please be advised - all display models are sold "as is" and the warranty covers the following items only: main burners (Gold Standard Lifetime Warranty), grates (Gold Standard Lifetime Warranty), burner covers (Gold Standard Lifetime Warranty). All warranties are subject to the review and approval of the manufacturer.

14520 DELTA LANE SUITE 105,  
HUNTINGTON BEACH, CA 92647  
800.966.8126  
AMDDIRECT.COM

### AMD DIRECT GAS APPLIANCES (GRILLS, SIDE/POWER BURNERS, & OVEN)

- Gold Standard Lifetime Warranty on construction and burner covers
- Gold Standard Lifetime Warranty on stainless steel construction
- Gold Standard Lifetime Warranty on cooking grates, burners, burner covers, valves, flame tamers, and heatzone separators, temperature gauges, & hood springs
- Gold Standard Lifetime Warranty on briquette systems
- 3 YEAR Warranty on all other parts, components, & electrical, including: LED bulb, wire harness, & switches; power source wire; transformer; interior halogen light wire & bulb

### VENT HOODS, REFRIGERATION, COLD STORAGE & SINKS

- VENT HOODS
- 5 Year Warranty on all Stainless Steel Construction
- 3 Year Warranty on blowers, LED Lighting, wiring harness and switches
- 18" & 24" REFRIGERATION MODELS
- 3 Year Warranty on all construction including compressors
- 1 Year Warranty on transformer, LED bulbs, LED harness, power source wire, LED switches, interior halogen light wire/bulbs
- 21" REFRIGERATION MODELS
- 1 Year Warranty on all construction & electrical components including compressor, transformer, LED bulb, LED harness, power source wire, LED switches, interior halogen light wire/bulbs
- COLD STORAGE & SINKS
- Gold Standard Lifetime Warranty on Ice Chests
- Gold Standard Lifetime Warranty on Grains & Flours

### DRAWERS, DOORS, GRILL LINERS, & CARTS

- Gold Standard Lifetime Warranty on construction, workmanship and materials for all stainless steel drawers, doors, grill liners, & carts
- 3 Year on electrical (Warming Drawers)

### COVERS

- Gold Standard Lifetime Warranty on covers, including grills, carts, sidepower burners & oven

### MADERA PRODUCTS

- Gold Standard Lifetime Warranty on construction, workmanship and materials for all stainless steel pans, hinges, drawer slides, gaskets, & magnets

### COMMERCIAL APPLICATIONS

- RESORT, ALTURI & TRL GRILLS
- Gold Standard Lifetime Warranty on workmanship, construction, & manufacturer defects for all commercial and/or hospitality applications
- Warranty is void upon misuse, including lack of regular cleaning, vandalism, or theft
- Commercial applications may require specific installation, maintenance, or repair of commercial applications (multiple users, lack of control of use, etc.) regular maintenance is mandatory



AMD Direct 

---

**CONTACT US**

14520 Delta Ln,  
Suite 105  
Huntington Beach, CA 92647

[AMDDirect.com](http://AMDDirect.com)

(800) 966-8126  
M-F 8:30 am – 5:00 pm (PST)

---

VER11622